

S

SS 3100S 2BG

2000S-1/2000S-2 SERIES HIGH SPEED DOUBLE NEEDLE LOCKSTITCH MACHINE 高速双针平缝机

使用说明书 & 零件样本

Operation Instruction & Parts Book

为了安全地使用，请您在使用之前一定阅读本使用说明书。另外，请您注意保管本使用说明书，以便随时查阅；零件更改设计时，恕不另行通知。

Read safety instructions carefully and understand them before using. Retain this Operation Instruction for future reference. Excuse for not notice in advance while the design of the sparepart has to be changed.



目 录

CONTENTS

使用说明 INSTRUCTIONS FOR OPERATION	1-9
零件样本 PARTS BOOK	10-33
1. 机壳部件 ARM BED AND IT'S ACCESSORIES	10-11
2. 夹线调节部件 THREAD TENSION REGULATOR MECHANISM	12-13
3. 上轴、压脚部件 UPPER SHAFT PRESSER FOOT MECHANISM	14-15
4. 针杆挑线部件 THREAD TAKE-UP LEVER NEEDLE BAR ROCK MOTION MECHANISM	16-17
5. 针杆挑线部件 THREAD TAKE-UP LEVER NEEDLE BAR ROCK MOTION MECHANISM	18-19
6. 针杆调节 NEEDLE BAR	20-21
7. 针杆变换机构部件 NEEDLE BAR FLIP-UP MECHANISM	22-23
8. 针距调节部件 STITCH REGULATOR MECHANISM	24-25
9. 下轴、送布轴部件 LOWER SHAFT AND FEED ROCK SHAFT MECHANISM	26-27
10. 旋梭台部件 HOOK SADDLE MECHANISM	28-29
11. 供油部件 OIL LUBRICATION MECHANISM	30-31
12. 附件 ACCESSORIES	32-33

使用说明

Instructions For Operation

操作前注意事项

① 安全预防

1. 打开电源后，将手指远离机针下面和周围及远离皮带轮。
2. 当机器不使用或操作者离开时，必须关掉电源。
3. 当倾斜机头、安装或卸下V型带、调整机器时，必须关掉电源。
4. 机器运转时，避免将手指、头发、棒状物等靠近主动轮、V型带、旋梭或马达，否则可能引起伤害。
5. 机器运转时，不要将手指插入挑线杆防护罩下、机针下面及周围或主动轮附近。
6. 如果安装了皮带轮、压脚防护罩、透明有机玻璃罩，则在这些防护设施不完善时不要开机。

② 开机须知

1. 如果油盘中无油，则不要开机。
2. 如果机器是靠人工滴油润滑的，则在充分润滑前不要开机。
3. 如果是新机器，则在开机之前核对皮带轮运转方向。
(观测者面对马达皮带轮，皮带轮应逆时针方向运转)。
4. 确认马达的额定电压和相位。

③ 操作条件

1. 不要在高于 35℃ 或低于 5℃ 时使用，否则会造成机器损坏。
2. 避免在肮脏的环境中使用机器。

PRECAUTIONS BEFORE STARTING OPERATION

① Safety Precautions

1. When turning the power on, keep your hands and fingers away from the area around/under the needle and the area around the pulley.
2. Power must be turned off when the machine is not in use, or when the operator leaves his/her seat.
3. Power must be turned off before tilting the machine head, installing or removing the "V" belt, adjusting the machine, or when replacing.
4. Avoid placing fingers, hairs, bars etc., Near the pulley, "V" belt, bobbin winder pulley, or motor when the machine is in operation. Injury could result.
5. Do not insert fingers into the thread take-up cover, under/around the needle, or pulley when the machine is in operation.
6. If a belt cover, finger guard, and/or eye guard are installed, do not operate the machine without these safety devices.

② Precautions before Starting Operation

1. If the machine's oil pan has an oil sump, never operate the machine before filling it.
2. If the machine is lubricated by a drop oiler, never operate the machine before lubricating.
3. When a new sewing machine is first turned on, verify the rotational direction of the pulley with the power on.
(The pulley should rotate counterclockwise when viewed from the pulley.)
4. Verify the voltage and (single or three) phase with those given on the machine nameplate.

③ Precautions for Operating Conditions

1. Avoid using the machine at abnormally high temperature (35°C or higher) or low temperatures (5°C or lower). Otherwise, machine failure may result.
2. Avoid using the machine in dusty conditions.

1 安装机针 How to attach needle

注：一定要先切断电源再装机针。
Note: Before attach needle, be sure to switch off the power source.

机针要碰到针杆孔底部为止，机针长槽要面对面。最后拧紧螺钉。
Insert the needle to the bottom of needle clamp and tight the screw, Keep the long groove face-to-face.

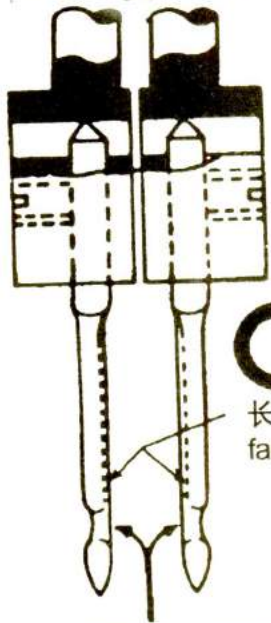

长槽面对面
face-to-face

机针没碰到针杆孔底部
Insufficient insertion

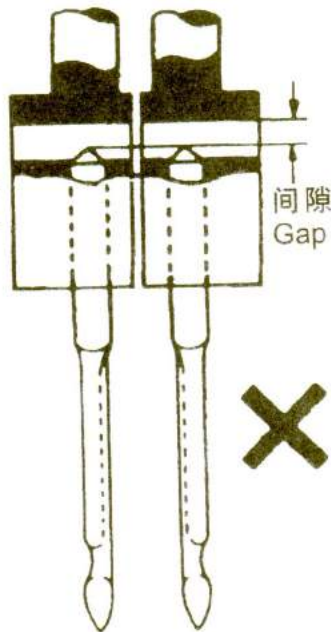

长槽方向装错
Wrong direction

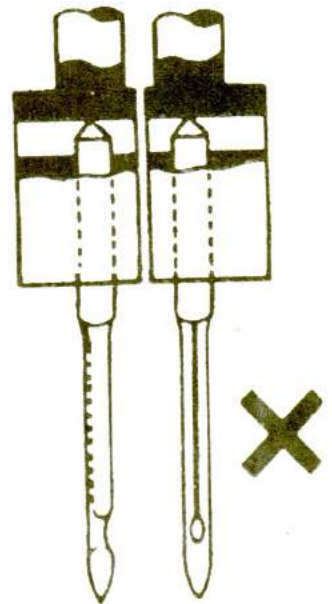

2 绕线调节法 How to wind the lower thread on the bobbin

注：空运转时一定要把压脚提起。
Note: Raise the presser foot while the sewing machine left out of use.

- 绕线压力的强弱 绕涤纶、尼龙线时，要减少绕线压力。
- 单边绕线 过线架朝绕线量少的方向移动。
- 绕线量调节 绕线量大时，旋松满线度调节螺钉，绕线量少时，拧紧螺钉。

Strength of winding: Particularly in the case of nylon or polyester thread, it is desirable that the bobbin is wound loosely enough.
Uneven winding: In the case of uneven winding, adjust the thread guide slightly toward the less wound part of bobbin to obtain even winding.
Winding amount of thread: When the winding amount of thread is excessive, loosen the adjusting screw and tighten when insufficient.

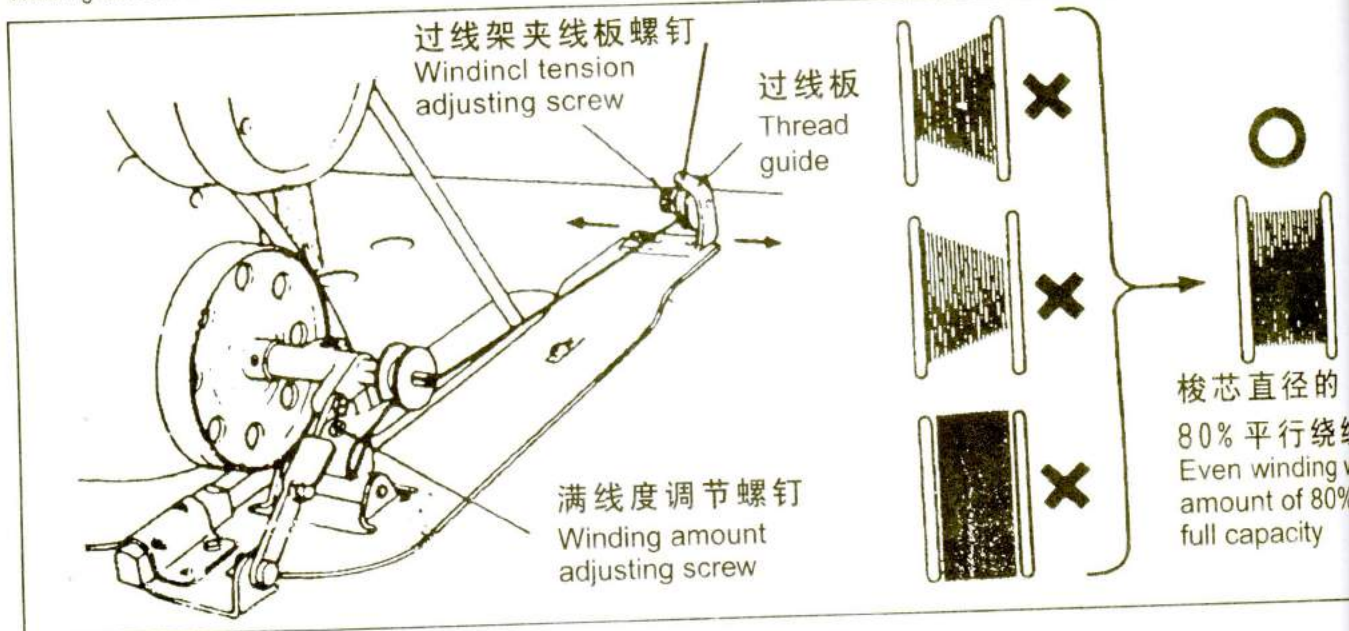

③ 穿面线方法

Threading

挑线杆上升至最高位置，按下列顺序穿线
Raise the thread take-up lever to its highest position and thread the upper thread in the following order.

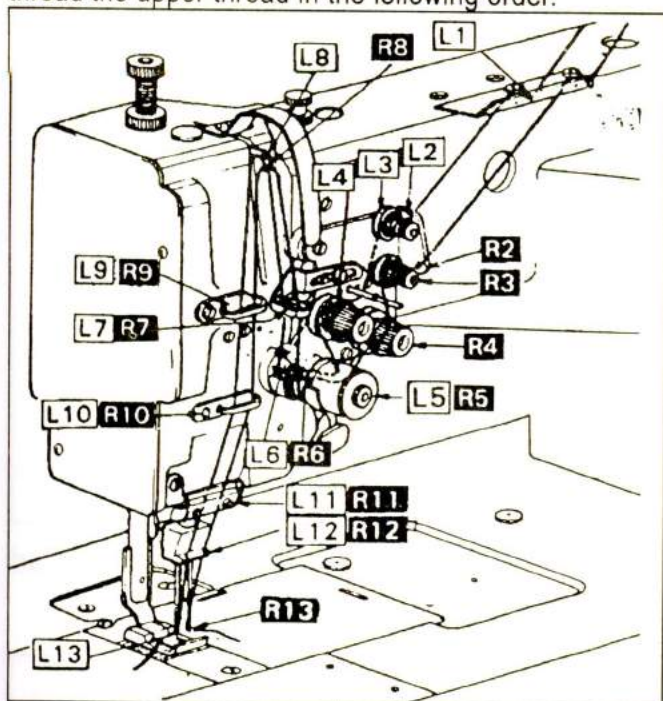

⑤ 线勾的调节 Adjusting of thread guide

根据缝料的厚薄调节线勾位置
Adjusting the thread guide according to the sewing materials conditions

线勾位置 Thread guide position	左 Left	中 Middle	右 Right
缝料 Materials	厚料 Heavy	M } 标准 B } Standard	薄料 Light
面线供给量 Upper thread	多 Increase	标准 Standard	少 Decrease

⑦ 梭芯装入旋梭的方法

Put the bobbin into the rotating hook

从梭芯抽出约5cm的线，如图所示方向拿住梭芯，然后装入旋梭。
Pull out thread about 5cm, hold the bobbin as shown, and put the bobbin into rotating hook.

④ 针距调节和倒缝

Adjusting of stitch length & reverse lever

注：压下倒缝操纵杆，转动针距标盘，调节针距。
倒缝……压下倒缝操纵杆
放开倒缝操纵杆，则恢复为顺缝。

For desired stitch length, push the reverse lever downward and adjust by stitch length dial.
Push the reverse lever downward, reverse sewing can be continued
When the reverse lever is released, reverse sewing return to forward sewing

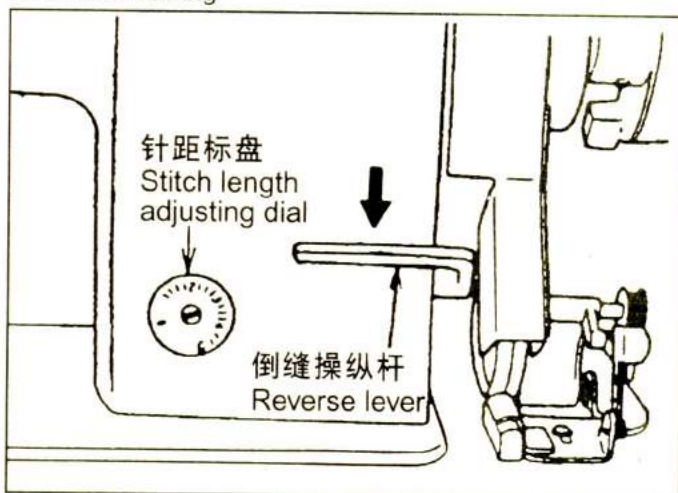

⑥ 压脚压力的调节

Adjusting pressure of presser foot

调压螺钉 Pressure regulating thumb screw

薄料 (弱) For light material (Weaken)
厚料 (强) For heavy material (Strength)

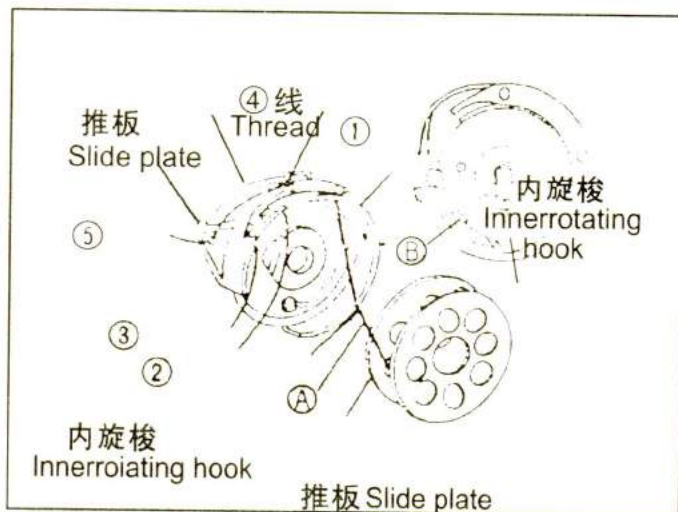
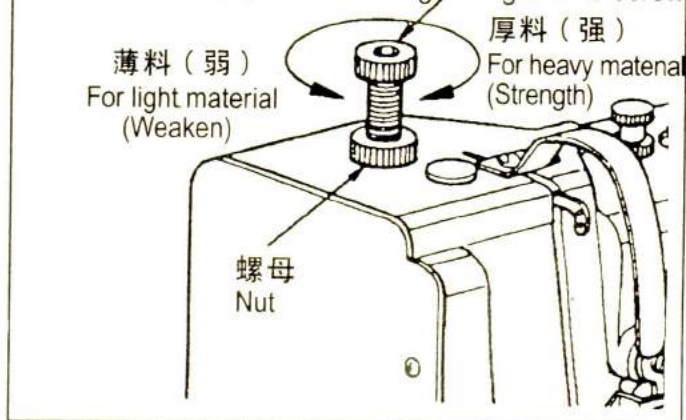

8 引底线的方法 Leading the lower thread

(1) 把底线从底板面上抽出。

Lead the lower thread to thread groove(1), pass thread through tongue(2), pull out lower thread over bed plate

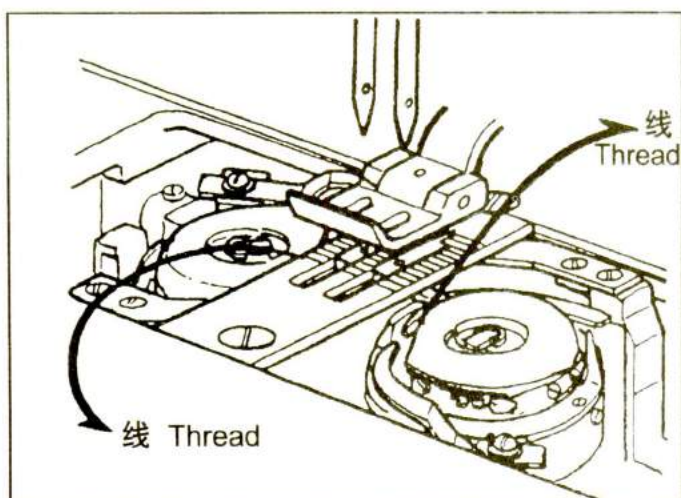

(2) 左手拉住两根面线，用右手慢慢转一圈皮带轮如图所示，面线拉起把底线也引出，然后拉齐从压脚下面拉过，放到对面。

Hold up upper thread by left hand, rotate the wheel by right hand, lower thread be led while upper thread pull out. make the length of upper thread and lower thread uniform, lead thread under the presser foot.

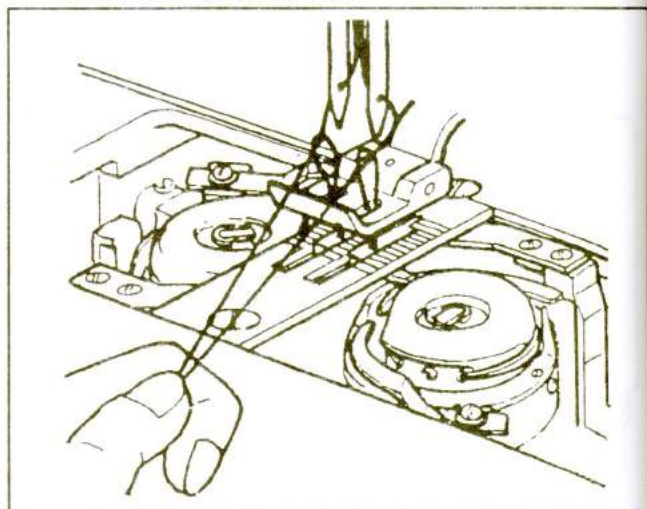

9 调节底线 Adjusting the lower thread



11 调节面线 Adjusting the upper thread

左右旋转面线调节螺母进行调节

Turn the upper thread adjusting stud left or right

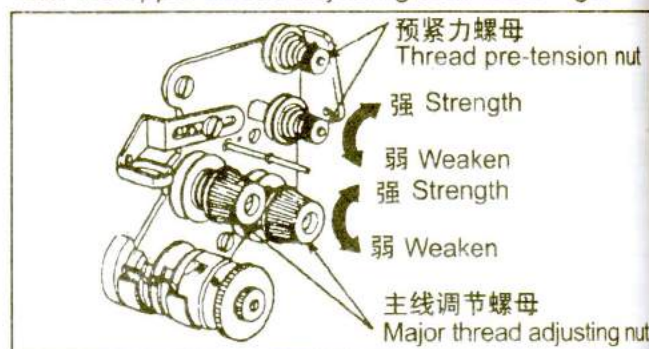

10 挑线簧的调节

Adjusting thread take-up spring

1. 挑线簧动作量的调节

-1. 左面线的挑线簧①：把定位块的止动螺钉②放松，调节定位块。

-2. 右面线的挑线簧④：把定位块的止动螺钉⑤放松，调节定位块⑥。

1. Adjusting the thread take-up spring stroke

-1. Thread take-up spring for left upper thread: Loosen the stop screw (2), adjusting the stopper block (3).

-2. Thread take-up spring for right upper thread: Loosen the stop screw (5), adjusting the stopper block (6).

2. 挑线簧强度的调节

-1. 调节左面线时，先放松固定螺母⑦及机头内部调节座螺钉(11)，然后调节夹线螺钉。调节结束，拧紧固定螺母及调节座螺钉即可。



-2. 调节右面线时，先放松紧固螺钉⑨，回转调节螺母⑩。调节结束，拧紧固定螺钉⑨进行固定。

2. Adjusting the thread take-up spring tension

-1. Thread take-up spring tension for left upper thread: Loosen the Nut (7) and Screw (11), then adjusting the tension screw. After adjustment, tighten the Nut (7) and Screw (11).

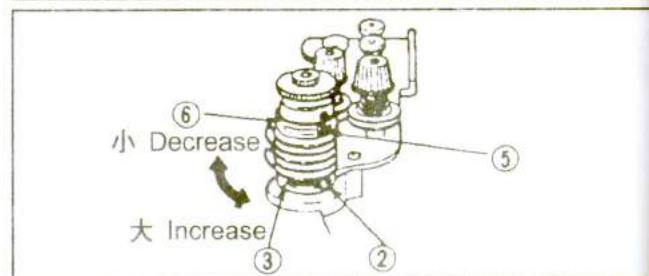
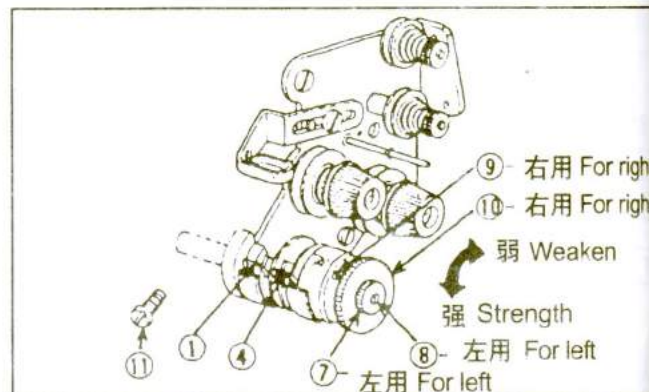
-2. Thread take-up spring tension for right upper thread: Loosen the Screw (9), adjusting the nut (10). After adjustment, tighten Screw (9).



故障状态 Problem	原因 Cause	简单的修理方法 Solution
跳针 Stitches skip	(1)针的原因 Needle ● 针弯曲 Needle is bent ● 针与线不相配 Size of needle and thread is not suitable	换新针 Insert new needle 根据线的粗细配适当型号的机针 Select proper needle for thread thickness
	(2)针没装好 Needle is not inserted correctly ● 针没装到底 Needle is not fully inserted ● 针装歪(如图) Installation of needle is crooked(see picture)  ● 针装反 Installation of needle is opposite	针要碰到针杆孔底部为止 Needle must be inserted fully into the bottom of needle bar 针孔要装直(如下图) Installation of needle must be straight(see the below picture)  针的长槽要面对面 Keep the long groove of needle face to face
松浮不紧 Stitches are loosened	(1)面线调节太松 Surface stitch is too loosened	面线调节螺母向右一点点调节至适度 Turn the surface stitch nut to the right side lightly until it gets the suitable place
	(2)挑线簧太软松 Stitch-spring is too soft	夹线调节螺钉一点点向左旋转, 挑线簧逐步变硬。 厚的材料(针脚长的)要求挑线簧较硬。 When the thread-holding nut turn left, the stitch-spring will become hard, heavy material (long needle foot) requires hard stitch-spring.
	(3)底线调节太松 Bottom stitch is too loosened	梭芯套上的梭皮螺钉逐渐调节至适度 Turn the screw of bobbin case to a suitable place.
线被切断 Needle thread breaks	(1)线的质量不好 The thread quality is too poor	调换成质量好的缝纫线, 不能使用粗细不均的线 Select good quality thread, don't use rough thread
	(2)针的原因 Needle cause ● 针弯曲 Needle is bent ● 针没装好 Needle is not well installed ● 与线相配的针太细 Needle size is too thin for thread	换新针 Insert new needle 参照跳针(2)项 See item (2) of stitches skip 用与线相配的机针 Select proper needle size for thread
	(3)面线张力太大 Thread tension too tight ● 两夹线板间线屑太多 Tension disc area lint excessive ● 梭芯绕线过慢或绕线不够 Bobbin winding too low or not enough ● 梭芯套里线屑太多 Bobbin case lint excessive ● 梭芯套上的梭皮歪斜(浮起)或折断 Bobbin case tension spring lean or break ● 梭芯装入梭芯套的方法不对 Bobbin in stalling not correct	面线调节螺母向左旋转, 减小张力, (如果是面线不紧而调得太紧的话, 先查清不紧的原因) Turn tension adjust nut post left, the pressure will be decreased, (if the thread tension not too tight, check the case first) 夹线组件调节螺母拧下后能全部分解, 把夹线板内面和夹线螺钉的过线槽清理干净。 Tension assembly complete adjust nut will be take apart, then clean them 正确绕线, 平行绕线且至梭芯外径的80% Correct wind the thread, wind parallel to bobbin diameter 80% 清除尘屑 Clean the lint  改正或换掉安装歪斜的 Correct or change them 梭芯装入梭芯套后, 拖动底线, 梭芯逆时针方向回转 Bobbin put in the bobbin case, pull the bottom stitch, turn the bobbin counterclockwise.
针角起皱 Fabric wrinkle	(1)对于被缝制的材料, 针、线太细 Refer to material of sewing needle, thread too small	对于被缝制得材料要用适当粗细得针和线, 特别是极薄的材料, 不能用过粗的针和线, 否则会起皱 The material sewing will be fit for the needle and thread, specially the light-weight material, not use too thick neele and thread, otherwise will wrinkle.
	(2)调节螺钉(底线、面线)调得太紧 Adjust nut (bottom stitch, surface stitch) Adjusting too tight.	调整面线调节螺母、挑线簧、梭芯套 Adjusting tension adjust nut, take-up spring, tension case.
	(8)压紧杆压得太紧 The thread take-up press too tight	压紧杆调压螺钉向右旋转, 减小压力(极薄材料要调低压力) Turn the set screw right, the press will be decreased (light-weight material under low press).

1 润滑 Lubrication (1)

油加到油盘中 H 位置。
 在使用中要定期检查，如果油量在 L 位置以下，
 请补加到 H 位置。
 请使用白色缝纫机油。

Pour oil up to the position H of oil tank.
 During operation, check the oil volume periodically, if oil lever
 is below the position L, replenish oil up to the position H
 Please use the Sewing Machine oil.

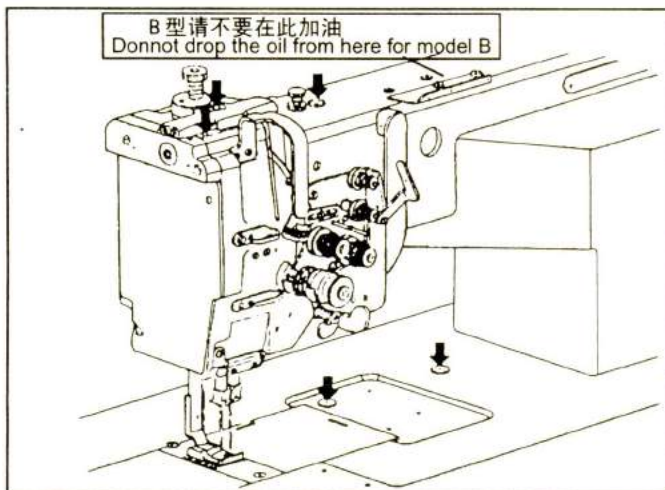
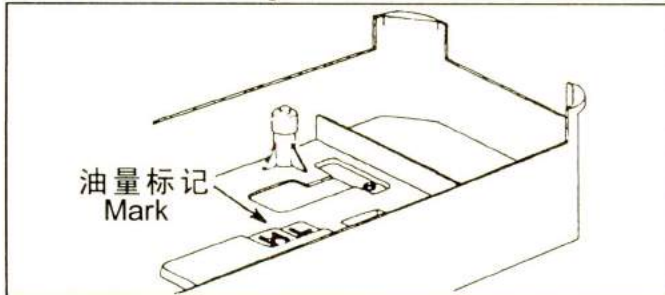

3 供油状态和调节挑线杆供油 Condition of oil lubrication & adjusting take-up lever lubrication

- (1) 运转过程中确认油窗里有油滴下。
- (2) 可调节给挑线杆组件加油的调节螺钉。
- (1) Be sure to the oil is splashing through the oil check window while sewing machine is operating
- (2) Adjusting the oil adjustmet screw

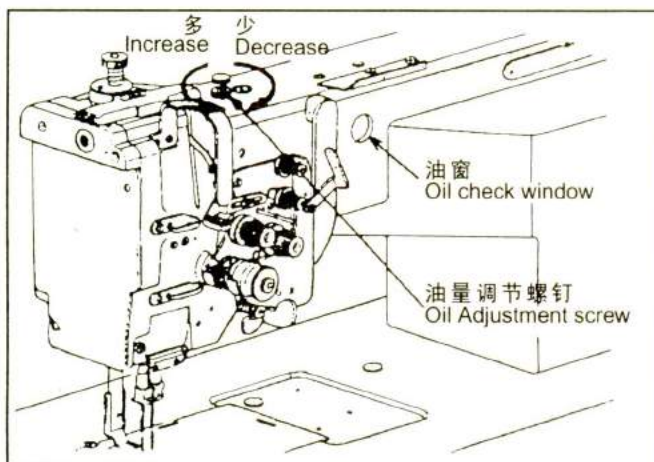

2 润滑 Lubrication (2)

新的缝纫机或长期不使用的缝纫机，在
 使用前要适量地加油（箭头所指）。

While a new sewing machine is first operated,
 or when a sewing machine left out of use for a
 long period of time is operated, it will be
 necessary to oil.

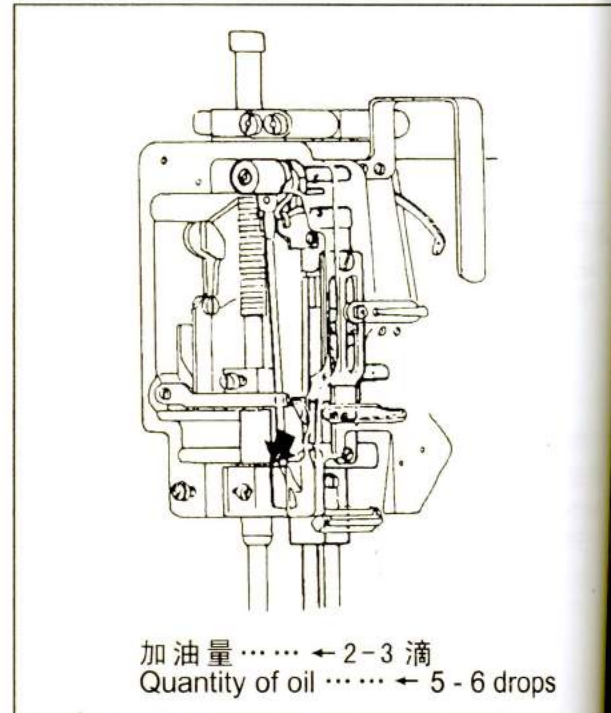

4 旋梭供油调节装置 Adjustment of hook lubrication

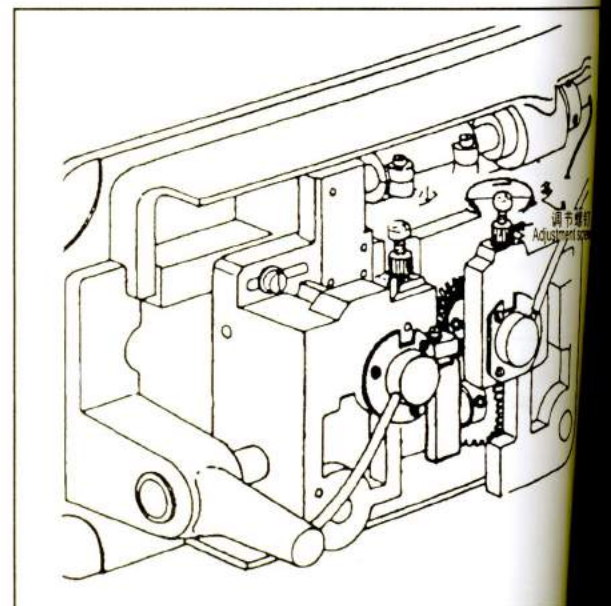

清洁 CLEANING

* 为了更好地保养和延长使用寿命，每天需进行下列清洁工作。此外，若长时间不使用机器，再次使用时，请按下列步骤进行操作。

* The following cleaning operations should be carried out each day in order to maintain the performance of this machine and to ensure a long service life.

Furthermore, If the sewing machine has not been used for a long period of time carry out the following cleaning procedures before using it again.

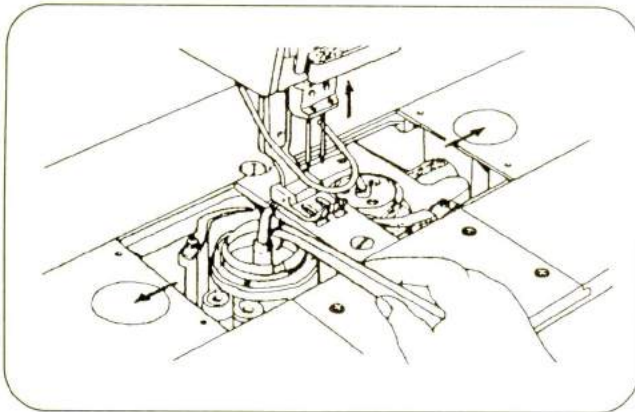

■ 清理旋梭

1. 转动上轮将机针提升到最高位置。
2. 打开左右推板。
3. 卸下梭心和梭帽。
4. 清理掉旋梭内所有碎线头。
5. 装上梭心和梭帽。

■ Cleaning the rotary hook

1. Turn the machine pulley to raise the needle to its highest position.
2. Open the left and right slide plates.
3. Remove the bobbin or the cap.
4. Remove all thread scraps from inside the rotary hook.
5. Replace the bobbin or the cap.

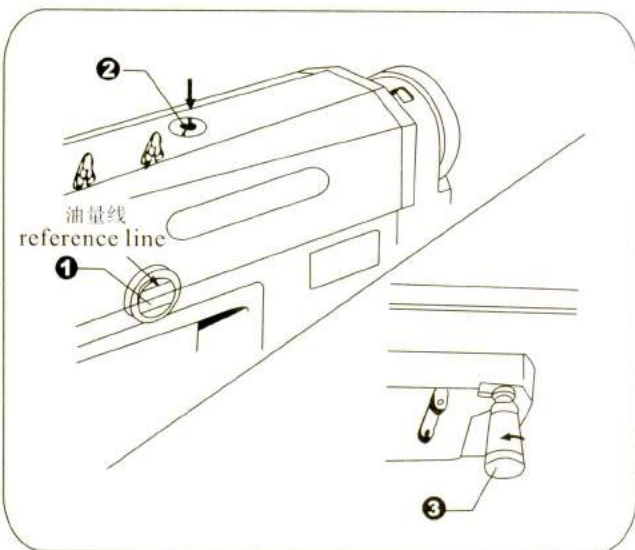

■ 再次加油

* 使用缝纫机10号润滑油。

1. 如果油量到油窗①下线，通过油孔②加油直到油量达到上线。
2. 若油壶③里的油已满，松开油壶③放掉里面的油。
3. 把油壶③旋回油盘上。

■ Oil replenishment

* Use only the lubricating oil.(Nisseki Sewing lube10)

1. If the oil level drops to the lower reference line in the oil sight glass ①, pour oil in through the oil inlet ② until the oil level rises to the upper reference line.
2. If the oil container ③ has filled with oil, unscrew the oil container ③ and dispose of the oil inside it.
3. Screw the oil container back into the oil pan

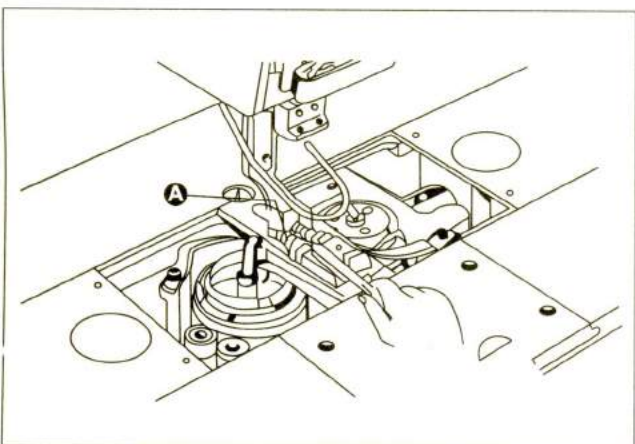

■ 送布牙的清扫

抬起压脚，取下针板，清扫送布牙A间距（牙槽）内的灰尘，然后再安好针板。

■ Cleaning feed dog

Pls uplift the press feet, take out the needle plate clean the dust bet ween part A, then install back the needle plate.

■ 润滑 Lubrication

根据6页的步骤进行润滑

Lubricate the sewing machine according to the procedur on page6.

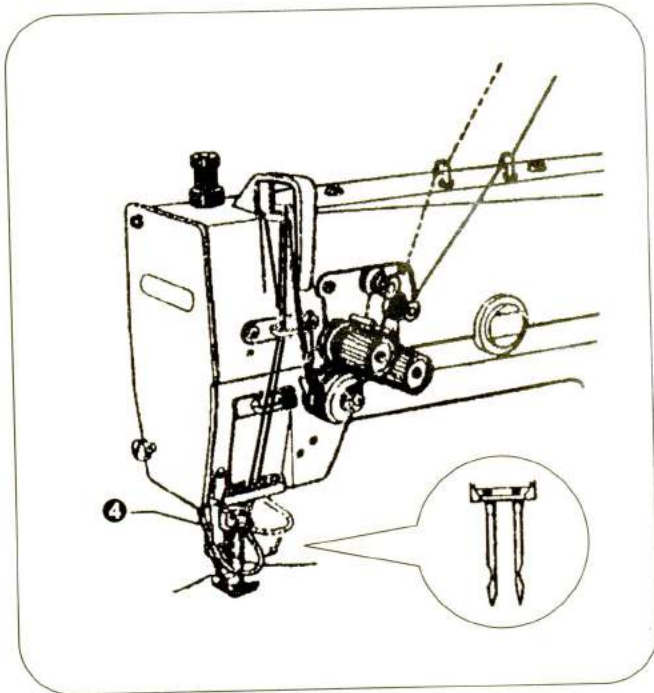

■ 检查

1. 检查上线是否正确。(参考16页)
2. 检查机针尾部是否损坏。
* 若机针尾部损坏, 应换新机针。
3. 放下护指架④。
4. 试缝。

■ Checking

1. Check tha the upper threads have benn threaded correctly.(Refer to page 16)
2. Check that the end of the needle is not broken. If the end of needle is broken, the needle should be replaced.
3. Lower the finger guard ④.
4. Carry out a test sewing.

2000S-1M/2M/1B/2B

型号 Model		2000S-1M	2000S-2M	2000S-1B	2000S-2B
规格 Specification		薄料-中厚料 Thin-Medium material		中厚料 Medium material	
用途 Material weight		薄料-中厚料 Thin-Medium material		中厚料 Medium material	
最高缝速 Max speed		4000rpm	3500rpm	3000rpm	3000rpm
针距长度 Stitch length		0~4mm	0~5mm	0~7mm	0~7mm
针杆行程 Needle bar stroke		33.4mm	33.4mm	35mm	33.4mm
压脚提升高度 Presser foot clearance		膝控 13mm 手动 7mm Kneel lifter 13mm Hand 7mm			
使用机针 Needle		DP × 5(标准#14) DP × 5 (Standard #14)		DP × 5(标准#18-#22) DP × 5 (Standard #18-#22)	
旋梭 Rotating hook		全回转自动加油水平旋梭 (标准旋梭) Rotary automatic lubrication Horizontal rotating hook (Standard rotating hook)		全回转自动加油水平旋梭 (2倍旋梭) Rotary automatic lubrication Horizontal rotating hook (Twice rotating hook)	
挑线杆 Take-up lever		滑杆式 Slide type			
针距调节 Adjustment of stitch		标盘式 Dial type			
供油方式 Lubrication		自动润滑 Automatic lubrication			
电机 Motor		离合器马达 370W Clutch motor 370W			
二针间距 Gap of two needles	标准 Standard	6.4mm			
	特殊 Special	2.4、4、5.6、3.2、4.8、8、9.5、12.7、16、19、25.4、28.5、31.8、38.1			

1. 机壳部件
ARM BED AND IT'S ACCESSORIES

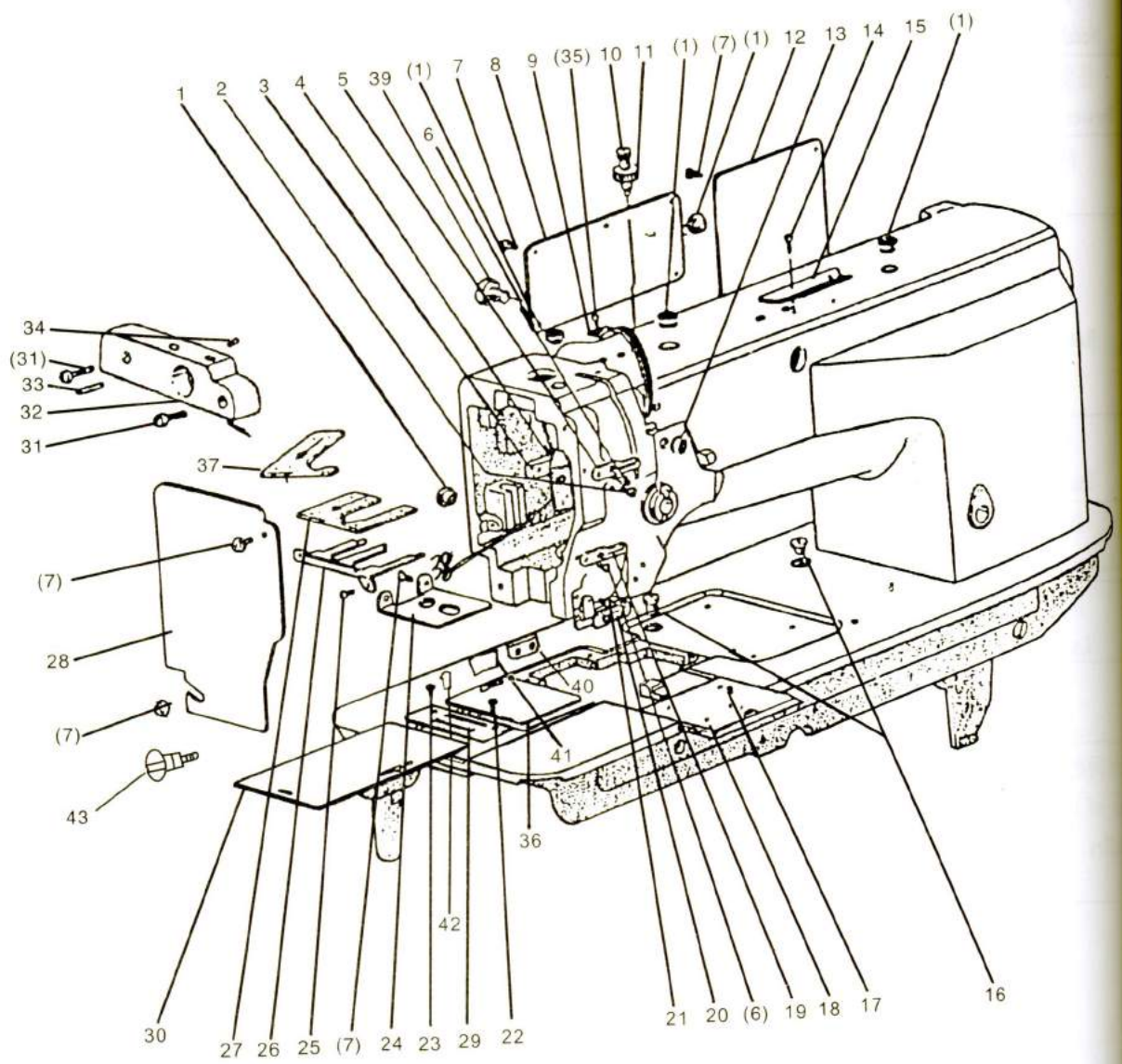

2、夹线调节部件 THREAD TENSION REGULATOR MECHANISM

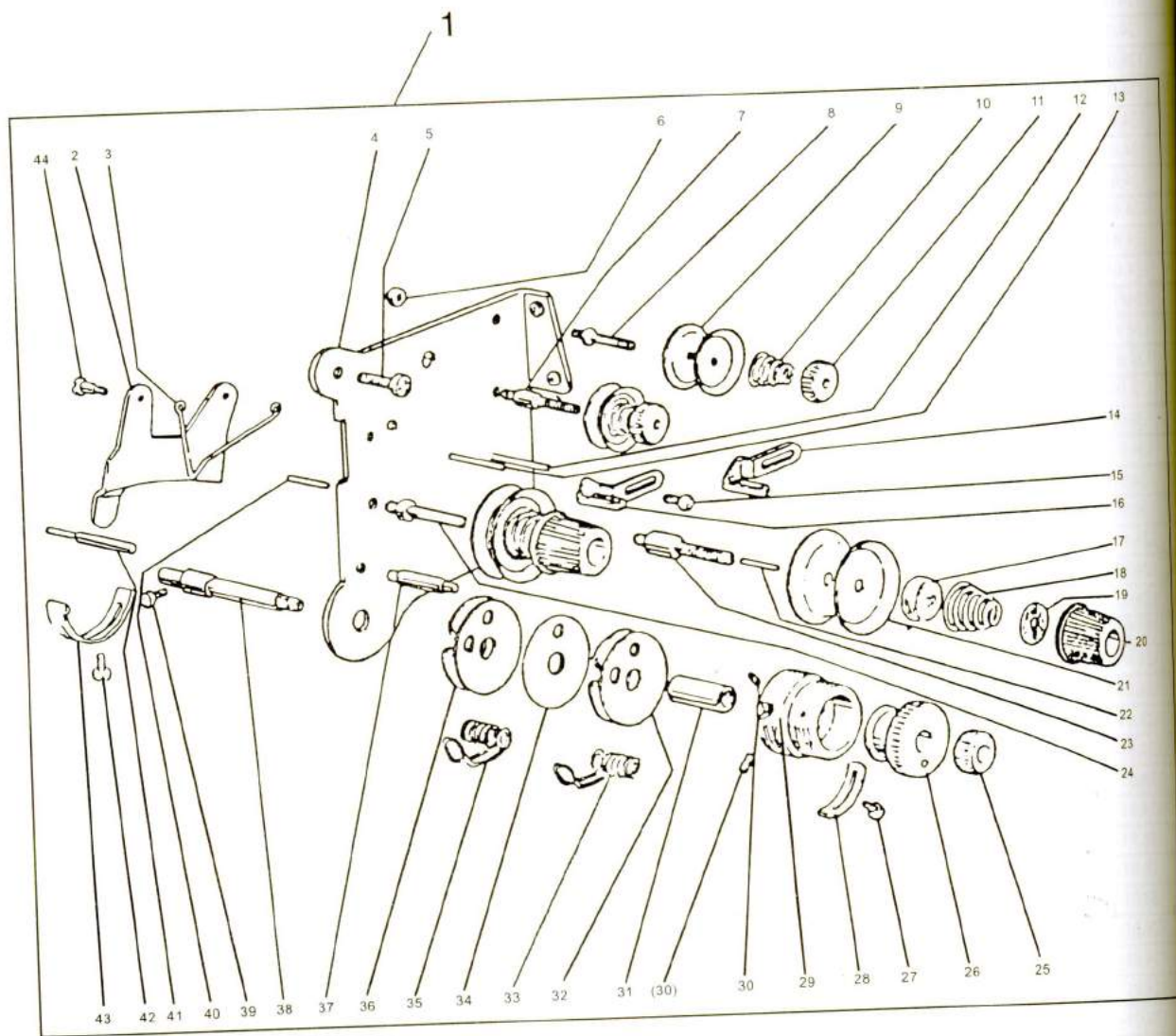

2. 夹线调节部件 THREAD TENSION REGULATOR MECHANISM

序号 NO.	图号 REF. NO.	老图号	零件名称	DESIGNATION	1M	1B	2M	2B
1	124.02-01	2403024	夹线组件	THREAD TENSION ARM.	1		1	
	126.02-01	2403025	夹线组件	THREAD TENSION ARM.		1		1
2	124.02-02	2303062	松线板	TENSION RELEASING PLATE	1	1	1	1
3	124.02-03	2304214	松线板压弹簧	TENSION RELEASING SPRING	1	1	1	1
4	124.02-04	2303068	夹线调节器安装板	MOUNTING PLATE	1	1	1	1
5	124.02-05	2301066	挑线杆防护罩螺钉	SCREW	2	2	2	2
6	124.02-06	2303060	螺母	NUT	2	2		
	128.02-06	GB-41-86-M5	螺母	NUT			2	2
7	124.02-07	2303416	夹线调节器螺钉	THREAD TENSION SPTING	1	1	1	1
8	124.02-08	2303036	夹线调节器螺钉	THREAD TENSION SPTING	1	1	1	1
9	124.02-09	2301022	夹线板	THREAD TENSION DISC	4	4	4	4
10	124.02-10	2303037	夹线弹簧	THREAD TENSION SPRING	2		2	1
	126.02-10	2303428	夹线弹簧	THREAD TENSION SPRING		2		
11	124.02-11	2303038	夹线螺母	THUMB NUT	2	2	2	2
12	124.02-12	2303035	过线销	PIN	2	2	2	2
13	124.02-13	2304201	夹线定位板销	PIN	1	1	1	1
14	126.02-14	2303427	线勾	GHREAD GUIDE		1		1
15	124.02-15	2301013	面板线勾螺钉	SCREW	1	1	1	1
16	124.02-16	2303040	夹线调节器线勾	GHREAD GUIDE	1		1	
17	124.02-17	2301031	松线板	THREAD TENSION RELEASING PLATE	2	2	2	2
18	124.02-18	2302022	夹线弹簧	THREAD TENSION SPRING	2			
	130.02-18	2303428	夹线弹簧	THREAD TENSION SPRING				2
19	124.02-19	2301037	夹线螺母止动板	THUMB NUT REVOLUTION STOPPER	2	2	2	2
20	124.02-20	2301029	夹线螺母小组件	THUMB NUT COMPLETE	2	2	2	2
21	124.02-21	2301032	夹线板	THREAD TENSION COMPLETE	4	4	4	4
22	124.02-22	2303064	过线钉	PIN	1	1		
	128.02-22	2303065	过线钉	PIN			1	1
23	124.02-23	2303059	夹线调节螺钉	THREAD TENSION STUD	1	1	1	1
24	124.02-24	2303039	夹线调节螺钉	THREAD TENSION STUD	1	1	1	1
25	124.02-25	2303047	螺母	THUMB NUT	1	1	1	1
26	124.02-26	2303046	套筒	TAKE-UP SPRING GUIDE	1	1	1	1
27	124.02-27	2303051	圆柱头螺钉	SCREW	1	1	1	1
28	124.02-28	2303050	止动块	STOPPER	1	1	1	1
29	124.02-29	2303049	导向套	THREAD TENSION POST	1	1	1	1
30	124.02-30	2303045	紧定螺钉	SCREW SM1/8"×44 L=3.9	2	2	2	2
31	124.02-31	2303048	轴套	BUSHING	1	1	1	1
32	124.02-32	2403028	过线板组件	PLATE COMPLETE	1	1	1	1
33	124.02-33	2303043	挑线簧	THREAD TAKE-UP SPRING	1	1	1	1
34	124.02-34	2303055	过线板	PLATE	1	1	1	1
35	124.02-35	2303042	挑线簧	THREAD TAKE-UP SPRING	1	1	1	1
36	124.02-36	2403027	过线板组件	PLATE COMPLETE	1	1	1	1
37	124.02-37	2303044	阶梯螺钉	SCREW	1	1	1	1
38	124.02-38	2303041	阶梯轴螺钉	THREAD TENSION STUD	1	1	1	1
39	124.02-39	2301241	摆动连杆轴螺钉	SCREW	1	1	1	1
40	124.02-40	2303065	过线钉	PIN	1	1		
	128.02-40	2303064	过线钉	PIN			1	1
41	124.02-41	2303066	松线钉	TENSION RELEASING PIN	1	1	1	1
42	124.02-42	2303025	圆柱头螺钉	SCREW SM9/64"×40 L=6.5	2	2	2	2
43	124.02-43	2303067	止动块	STOPPER	1	1	1	1
44	124.02-44	2303061	松线板螺钉	SCREW	2	2	2	2

3、上轴压脚部件 UPPER SHAFT PRESSER FOOT MECHANISM

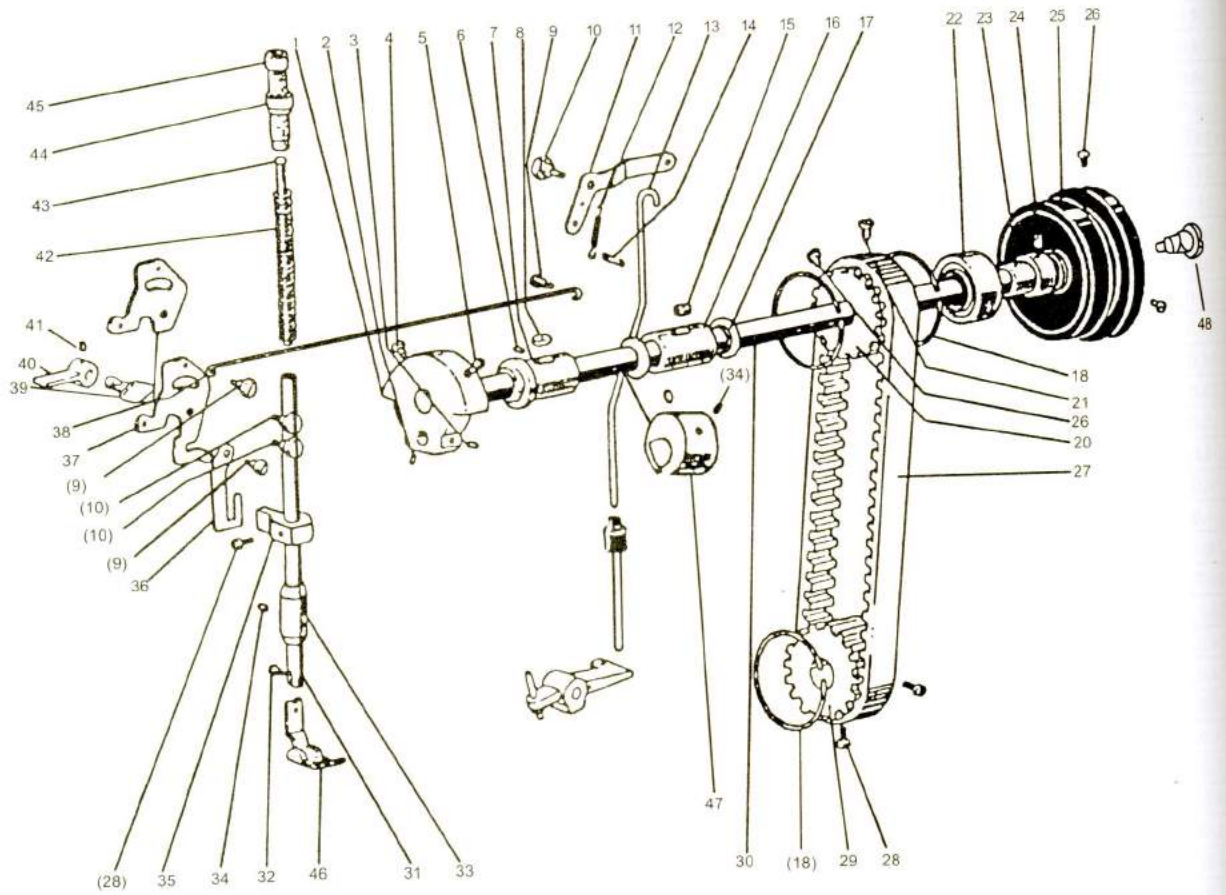

3.上轴压脚部件 UPPER SHAFT PRESSER FOOT MECHANISM

序号 NO.	图号 REF. NO.	老图号	零件名称	DESIGNATION	1M	1B	2M	2B
1	124.03-01	2303093	针杆曲柄	NEEDLE BAR CRANK COMPLETE	1			
	126.03-01	2303444	针杆曲柄	NEEDLE BAR CRANK COMPLETE		1		
	128.03-01	2303493	针杆曲柄	NEEDLE BAR CRANK COMPLETE				
2	124.03-02	2301086	上轴紧圈螺钉	SCREW SM1/4"×40 L=8	1	1	1	1
3	124.03-03	2301068	挑线曲柄定位螺钉	SCREW SM1/4"×40 L=6	1	1	1	1
4	124.03-04	2301069	针杆曲柄螺钉	SCREW SM9/32"×28 L=13	2	1	1	1
5	124.03-05	2301070	针杆曲柄定位螺钉	SCREW	1	1	1	1
6	124.03-06	2304042	挑线杆定位螺钉	SCREW	1	1	1	1
7	124.03-07	2303003	上轴轴套(左)	ARM SHAFT BUSHING COMPLETE(LEFT)	1	1	1	1
8	124.03-08	2303002	羊毛毡	FELT	2	2	2	2
9	124.03-09	2301185	铰链螺钉	SCREW	1	1	1	1
10	124.03-10	2301361	膝控提升杠杆(右)螺钉	SCREW	3	3	3	3
11	124.03-11	2303215	膝控提升杠杆(右)	KNEE LIFTER LEVER (RIGHT)	1	1	1	1
12	124.03-12	2303216	膝控提升杠杆(右)弹簧	KNEE LIFTER LEVER (RIGHT) SPRING	1	1	1	1
13	124.03-13	2303217	膝控提升边杆	KNEE LIFTER CONNECTING	1	1	1	1
14	124.03-14	2303218	弹簧销	SPRING PIN	1	1	1	1
15	124.03-15	2303012	羊毛毡	FELT	2	2	2	2
16	124.03-16	2303011	上轴轴套(中)	ARM SHAFT BUSHING COMPLETE (MIDDLE)	1			
17	124.03-17	2303607	上轴油封	OIL SEAL	2			
18	124.03-18	2303099	弹簧挡圈	SPRING FLANGE	3	3	3	3
19	124.03-19	2301120	同步带轮螺钉	SCREW SM15/64"×28 L=10	1	1	1	1
20	124.03-20	2303095	同步带轮	PULLEY	1	1	1	1
21	124.03-21	2301148	倒缝操纵杆曲柄螺钉	SCREW	1	1	1	1
22	124.03-22	2303337	轴承	BUSHING	1	1	1	1
23	124.03-23	2303336	轴套	BUSHING	1	1	1	1
24	124.03-24	2301120	轴套螺钉	SCREW SM15/64"×28 L=10	2	2	2	2
25	124.03-25	2303335	主动轮	PULLEY	1	1	1	1
26	124.03-26	2301092	主动轮螺钉	SCREW SM15/64"×28 L=12	3	3	3	3
27	124.03-27	2303097	同步带	COG BELT	1	1	1	1
28	124.03-28	2301120	同步带轮螺钉	SCREW SM15/64"×28 L=10	2	2	2	2
29	124.03-29	2303098	同步带轮	PULLEY	1	1	1	1
30	124.03-30	2303092	上轴	ARM SHAFT	1	1	1	1
31	124.03-31	2303147	压紧杆	PRESSER BAR	1	1	1	1
32	124.03-32	2303148	圆柱头螺钉	SCREW	1	1	1	1
33	124.03-33	2303414	压紧杆轴套	PRESSER BAR GUIDE BRACKET	1	1	1	1
34	124.03-34	2301064	上轴轴套(中)螺钉	SCREW SM11/64"×40 L=5.5	2	1	3	3
35	124.03-35	2303209	压紧杆导架	PRESSER BAR GUIDE BRACKET	1	1	1	1
36	124.03-36	2303214	操纵杆	OPERATION PLATE	1	1	1	1
37	124.03-37	2303212	膝控提升杠杆(左)	KNEE LIFTER LEVER (LEFT)	1	1	1	1
38	124.03-38	2303213	膝控提升拉杆	KNEE LIFTER ROD	1	1	1	1
39	124.03-39	2303211	压紧杆提升凸轮	DRESSER BAR LIFTING CAM	1	1	1	1
40	124.03-40	2303210	压脚板手	PRESSER BAR LIFT	1	1	1	1
41	124.03-41	2301027	三眼线勾螺钉	SCREW SM11/64"×40 L=5.5	2	2	2	2
42	124.03-42	2303219	压紧杆弹簧	PRESSER BAR SPRING	1	1	1	1
43	124.03-43	2301006	压紧杆弹簧导柱	PRESSER BAR SPRING GUIDE	1	1	1	1
44	128.03-44	2301198	调压螺钉锁紧螺母	SPECIAL NUT	1	1		
45	124.03-45	2302059	调压螺钉	SCREW	1	1	1	1
46	124.03-46	2403111	压脚组件	PRESSER FOOT COMPLETE(1/4)	1		1	
	126.03-46	2403112	压脚组件	PRESSER FOOT COMPLETE(1/4)		1		1
47	128.03-47	2303495	平衡偏心轮	BALANCE ECCENTRIC WHEEL			1	1
48	124.03-48	2301294	上轴轴端螺钉	SCREW SM11/32"×28	1	1	1	1

4. 针杆挑线部件 THREAD TAKE-UP LEVER NEEDLE BAR ROCK MOTION MECHANISM

序号 NO.	图号 REF. NO.	老图号	零件名称	DESIGNATION	1M	1B	2M	2B
1	124.04-01	2304036	棉线	OIL WICK	1	1		
2	124.04-02	2303012	挑线杆铰链轴	THREAD TAKE-UP GUIDE BRACKET PIN	1	1		
3	124.04-03	2303100	挑线杆	THREAD TAKE-UP LEVER	1			
	126.04-03	2304232	挑线杆	THREAD TAKE-UP LEVER		1		
4	124.04-04	2303101	挑线杆滑块	THREAD TAKE-UP LINK	1			
	126.04-04	2304034	滑杆	THREAD TAKE-UP LINK		1		
5	124.04-05	2303104	滑杆塞子	PLUG	1	1		
6	124.04-06	2301092	主动轮螺钉	SDREW SM15/64"×28 L=12	3	3		
7	124.04-07	2304040	挑线曲柄边杆轴	NEEDLE BAR CRANK PIN	1	1		
8	124.04-08	2304041	滑杆棉线	OIL WICK	1	1		
9	124.04-09	2301068	挑线曲柄定位螺钉	SCREW SM1/4"×40 L=6	1	1		
10	124.04-10	2303126	紧圈	COLLER COMPLETE	1	1		
11	124.04-11	2301095	压紧杆导架螺钉	SCREW SM15/64"×28 L=7	1	1		
12	124.04-12	2303004	针杆架摆动轴轴套	NEEDLE BAR ROCK SHAFT BUSHING	2	2		
13	124.04-13	2303114	针杆摇动轴	NEEDLE BAR ROCK SHAFT	1	1		
14	124.04-14	2301207	压脚曲柄(右)螺钉	SCREW SM1/4"×24 L=16	1	1		
15	124.04-15	2303127	针杆摇动轴曲柄	NEEDLE BAR ROCK SHAFT CRANK	1	1		
16	124.04-16	2303131	油线	OIL WICK	1	1		
17	124.04-17	2303230	圆柱头螺钉	SCREW	1	1		
18	124.04-18	2303129	针杆摇动轴曲柄连杆	LINK	1	1		
19	124.04-19	2303132	六角螺母	NUT	1	1		
20	124.04-20	2303119	羊毛毡	FELT	1	1		
21	124.04-21	2303122	圆柱头螺钉	SCREW SM1/8"×44 L=4.8	2	2		
22	124.04-22	GB-93-87-3	弹簧垫圈	WASHER	4	4		
23	124.04-23	2303120	保持架	HOLDER	1	1		
24	124.04-24	2303121	机针	NEEDLE	2			
	126.04-24	2303445	机针	NEEDLE		2		
25	124.04-25	2303115	圆柱头螺钉	SCREW	2	2		
26	124.04-26	2303109	针杆	NEEDLE BAR	1	1		
27	124.04-27	2303106	针杆架	NEEDLE BAR ROCK FRAME	1	1		
28	124.04-28	2303107	垫片	WASHER	2	2		
29	124.04-29	2303108	沉头螺钉	SCREW SM3/32"×56 L=4	4	4		
30	124.04-30	2303111	圆柱头螺钉	SCREW SM9/64"×40 L=8.5	1	1		
31	124.04-31	2303110	针杆接头	NEEDLE BAR CONNECTING STUD	1	1		
32	124.04-32	2303124	垫片	WASHER	1	1		
33	124.04-33	2303125	羊毛毡	FELT	1	1		
34	124.04-34	2303113	针杆接头滑块	SQUARE BLOCK	1	1		
35	124.04-35	2303112	挑线连杆	THREAD TAKE-UP LINK	1	1		
36	124.04-36	2303118	保持架	HOLDER	1	1		
37	124.04-37	2303123	圆柱头螺钉	SCREW SM1/8"×44 L=3.5	2	2		
38	124.04-38	2303117	羊毛毡	FELT	1	1		
39	124.04-39	2301064	上轴轴套(中)螺钉	SCREW SM15/64"×28 L=10	1	1		
40	124.04-40	2303116	机针夹头	HOLDER	1	1		

5、针杆挑线部件

THREAD TAKE-UP LEVER NEEDLE BAR ROCK MOTION MECHANIS

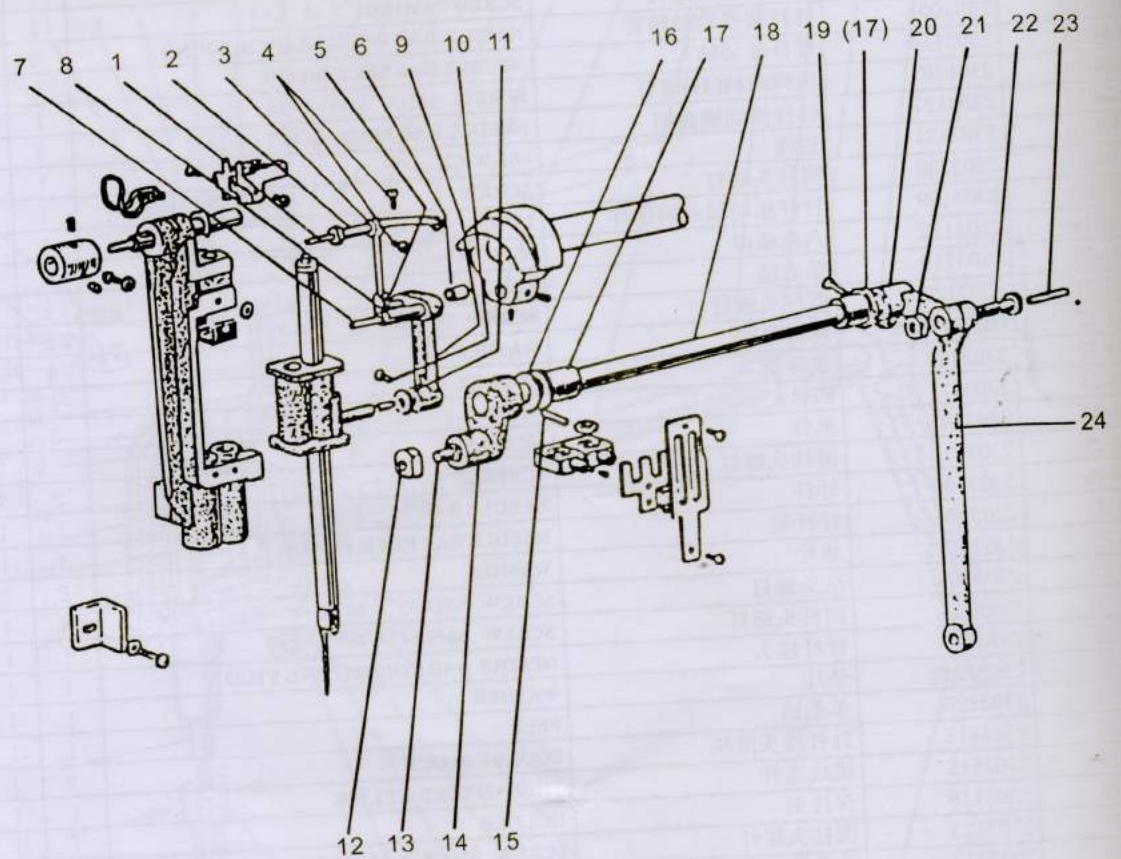

6、针杆调节 NEEDLE BAR

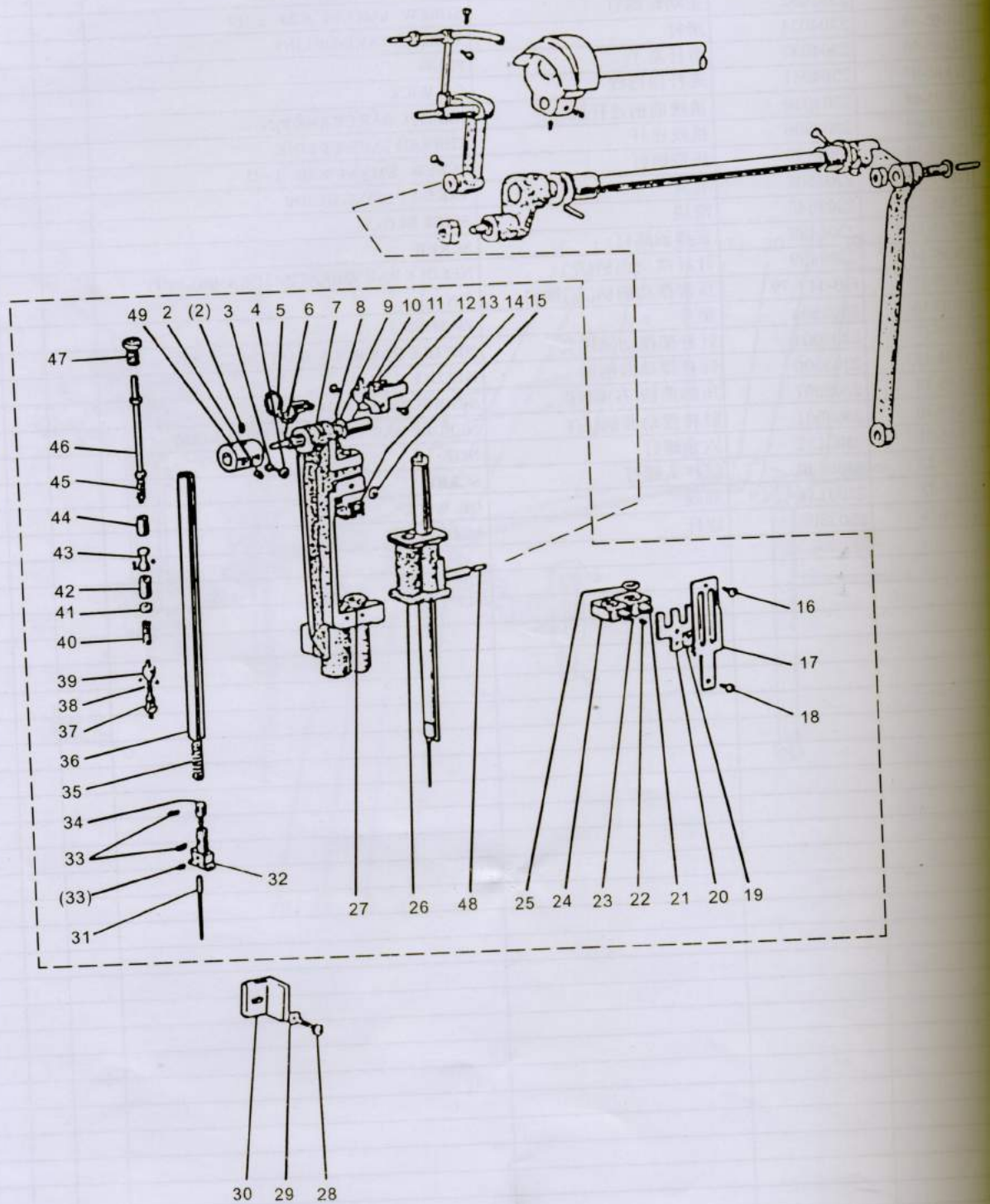

6. 针杆调节 NEEDLE BAR

序号 NO.	图号 REF. NO.	老图号	零件名称	DESIGNATION	1M	1B	2M	2B
1	128.06-01	2403068-1	针杆支架组件	NEEDLE BAR ROCK SHAFT ASSY			1	1
2	128.06-02	2301110	送布轴轴套螺钉	SCREW SM15/64"×28 L=4.5			2	1
3	128.06-03	2303051	螺钉	SCREW SM9/64"×40 L=6			1	1
4	128.06-04	2303541	板簧	SPING			1	1
5	128.06-05	2303544	油线	OIL WICK			1	1
6	128.06-06	2303548	油线	OIL WICK			1	1
7	128.06-07	2303508	针杆支架	NEEDLE BAR ROCK SHAFT			1	1
8	128.06-08	2303218	弹簧销	SPING PIN			1	1
9	128.06-09	GB896-86-7	E型挡圈	RETAINING RING			1	1
10	128.06-10	2303547	变换曲柄轴	CHANGE OVER CRANK SHAFT			1	1
11	128.06-11	2303539	油管夹	HOLDER			1	1
12	128.06-12	2303538	油管夹	HOLDER			1	1
13	128.06-13	2303543	圆柱头螺钉	SCREW SM9/64"×40 L=4			1	2
14	128.06-14	2303536	止动块	STOPER			2	1
15	128.06-15	2303420	检测器架垫圈	WASHER			1	1
16	128.06-16	2303542	圆柱头螺钉	SCREW SM9/64"×40 L=6.5			1	1
17	128.06-17	2303535	导向板	GUIDE PLATE			1	1
18	128.06-18	2303142	盘头螺钉	SCREW SM9/64"×40 L=5			1	1
19	128.06-19	2303534	沉头螺钉	SCREW SM3/32"×56 L=4.2			1	2
20	128.06-20	2303533	支架	BAR ROCK SHAFT			2	1
21	128.06-21	2303528	针杆夹头	HOLDER			1	1
22	128.06-22	2303532	内六角紧定螺钉	SCREW SM9/64"×40 L=3.5			1	2
23	128.06-23	2303531	铜塞	COPPER TUCK			2	2
24	128.06-24	2303530	针杆夹头	HOLDER			1	1
25	128.06-25	2303529	垫片	WASHER			4	4
26	128.06-26	2303526	针杆夹头	HOLDER			1	1
27	128.06-27	2303510	针杆轴套	NEEDER BAR			2	2
28	128.06-28	2303497	六角带槽螺栓	SCREW			1	1
29	128.06-29		垫片	WASHER			1	1
30	128.06-30	2303496	针杆导向块	NEEDLE GUIDE CAKE			2	2
31	128.06-31	2303397	机针	NEEDLE			2	
	130.06-31	2303445	机针	NEEDLE				2
32	130.06-32	2303608	机针夹头	SCREW			2	2
33	128.06-33	2303045	紧定螺钉	SCREW SM1/8"×44 L=3.9			4	4
34	128.06-34	2303524	止动块	STOPPER			2	2
35	128.06-35	2303515	弹簧	SPING			2	2
36	128.06-36	2303509	针杆	NEEDLE BAR			2	2
37	128.06-37	2303520	三角销螺栓	SCREW			2	2
38	128.06-38	2303540	钢球	BALL BEARING			12	12
39	128.06-39	2303519	滚筒	ROLLER			2	2
40	128.06-40	2303521	弹簧	SPING			2	2
41	128.06-41	2303518	六角螺母	NUT			2	2
42	128.06-42	2303517	特殊螺母	NUT			2	2
43	128.06-43	2303514	特殊销	PIN			2	2
44	128.06-44	2303513	套筒	BUSH			2	2
45	128.06-45	2303512	弹簧	SPING			2	2
46	128.06-46	2303516	阶梯销	BUSH			2	2
47	128.06-47	2303523	特殊螺钉	SCREW			1	1
48	128.06-48	2303125	羊毛毡	FELT				1
49	128.06-49	2303549	套筒	BUSH			1	1

7、针杆变换机构部件

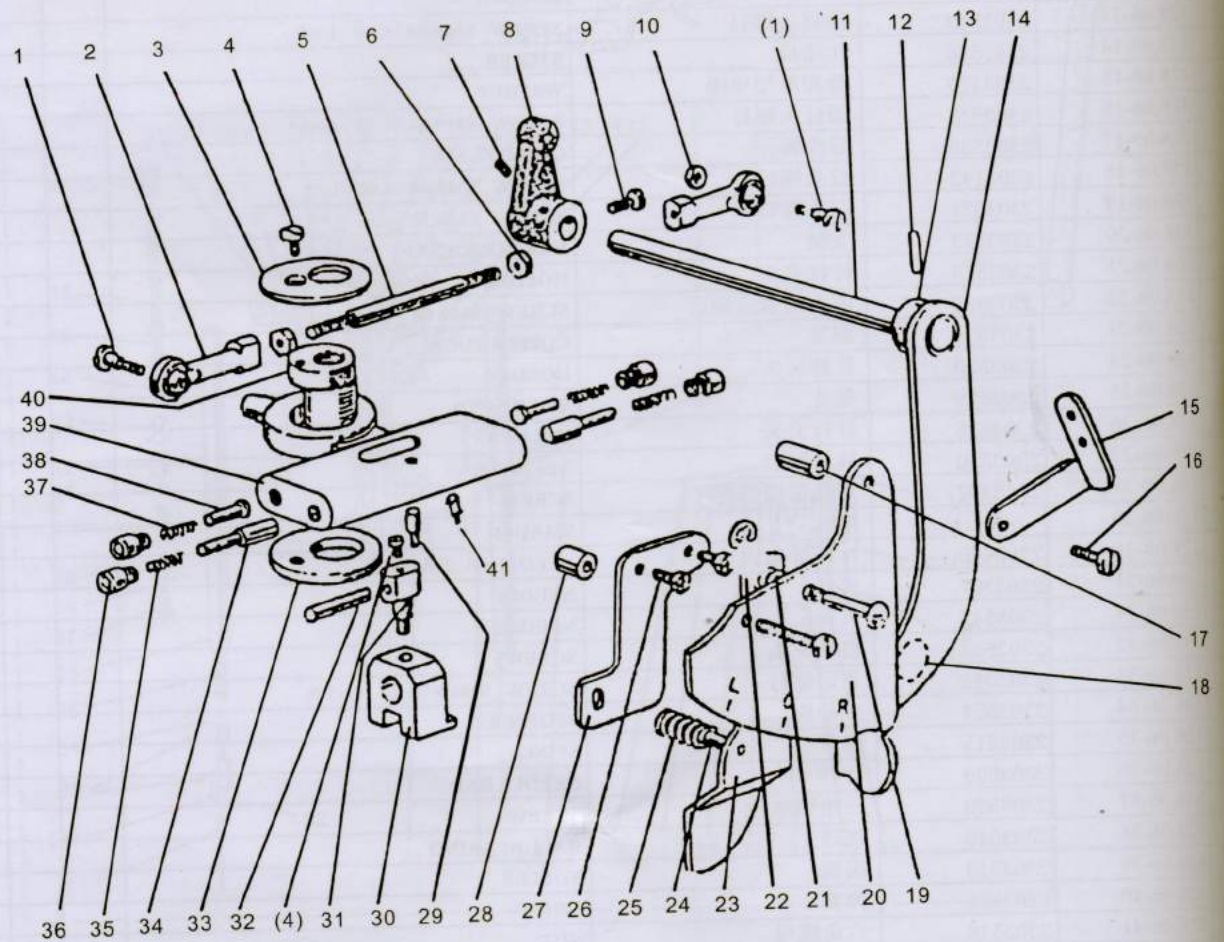

8、针距调节部件

STITCH REGULATOR MECHANISM

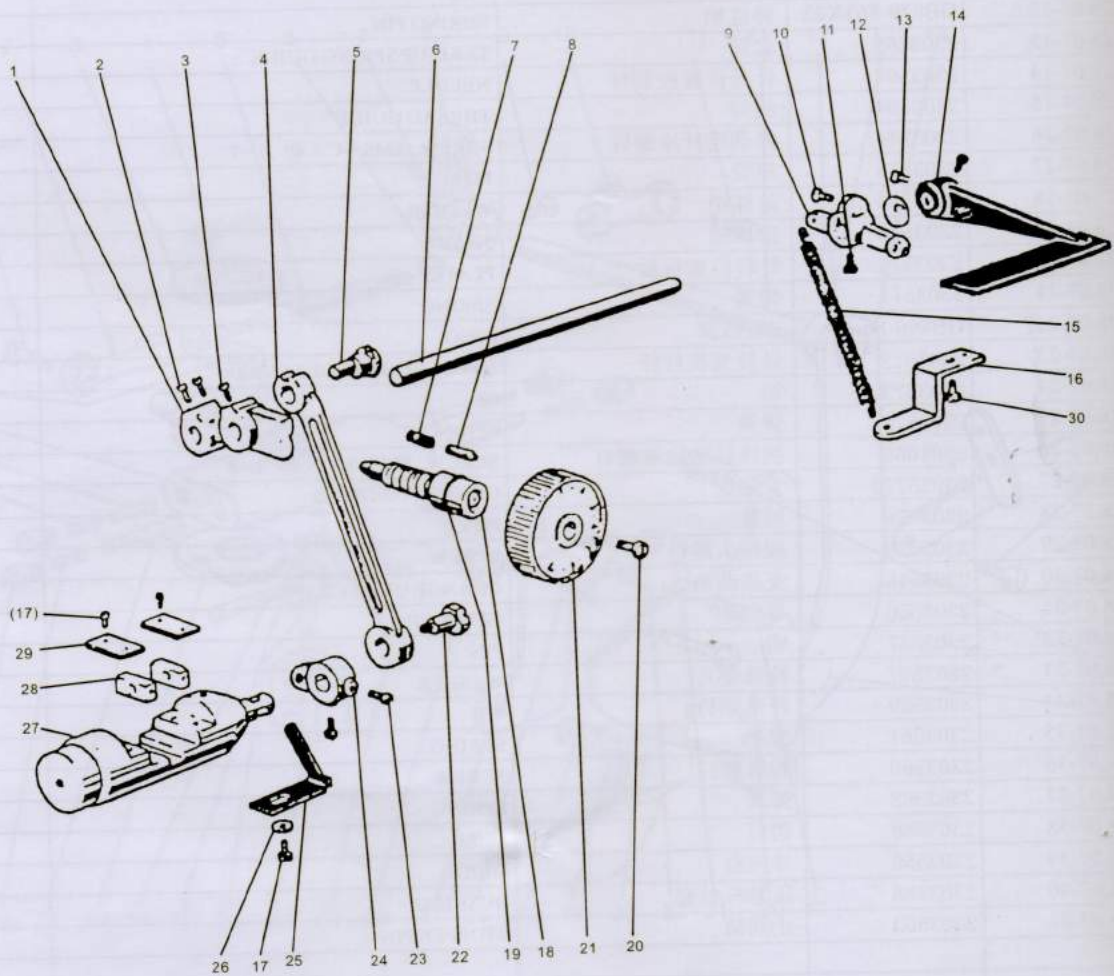

9、下轴、送布轴部件

LOWER SHAFT AND FEED ROCK SHAFT MECHANISM

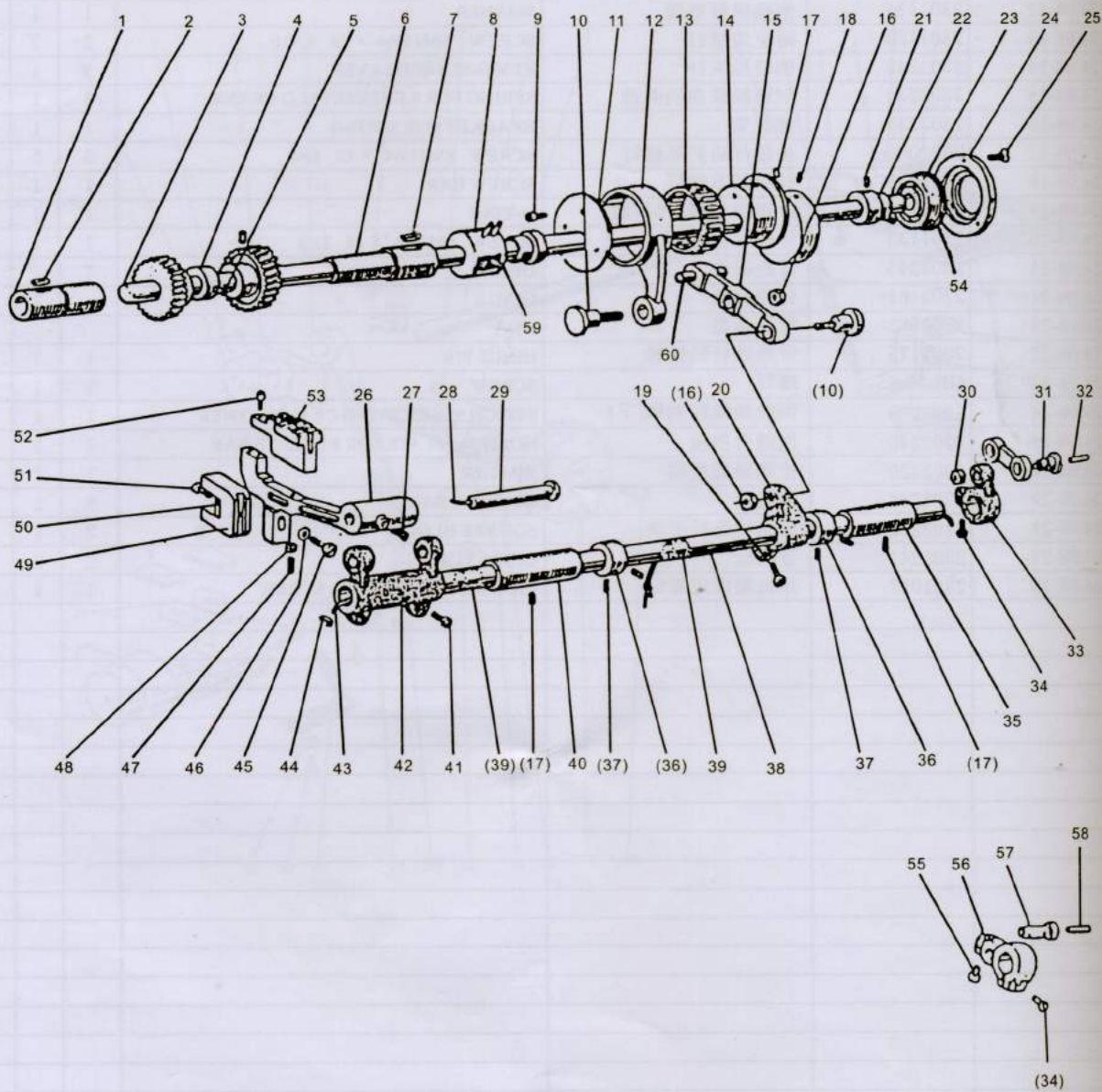

9.下轴、送布轴部件 LOWER SHAFT AND FEED ROCK SHAFT MECHANISM								
NO.	REF. NO.	老图号	零件名称	DESIGNATION	1M	1B	2M	2B
1	124.09-01	2303005	下轴轴套(左)	LOWER SHAFT BUSHING(LEFT)	1	1	1	1
2	124.09-02	2303006	油线	OIL WICK	1	1	1	1
3	124.09-03	2303285	下轴	LOWER SHAFT	1	1	1	1
4	124.09-04	2303290	抬牙凸轮	LOWER LIFTING CAM	1	1	1	1
5	124.09-05	2303289	紧定螺钉	SCREW SM1/4"×40 L=5	1	1	1	1
6	124.09-06	2303007	下轴轴套(右)	LOWER SHAFT BUSHING(RIGHT)	1	1	1	1
7	124.09-07	2303006	油线	OIL WICK	1	1	1	1
8	124.09-08	2303009	下轴轴套(中)	LOWER SHAFT BUSHING(MIDDLE)	1	1	1	1
9	124.09-09	2303423	短轴端盖螺钉	SCREW	3	3	3	3
10	124.09-10	2303264	轴位螺钉	SCREW	2	2	2	2
11	124.09-11	2303268	垫片	WASHER	1	1	1	1
12	124.09-12	2303270	送布凸轮连杆	FEED CONNECTING ROD	1	1	1	1
13	124.09-13	2303269	轴承	NEEDLE BEARING	1	1	1	1
14	124.09-14	2303267	送布凸轮	LEVER FEED CONNECTING SCM	1		1	1
	124.09-14	2303463	送布凸轮	LEVER FEED CONNECTING SCM		1		
15	124.09-15	2303260	送布轴连杆	LINK	1	1	1	1
16	124.09-16	2303265	六角螺母	NUT	2	2	2	2
17	124.09-17	2301064	上轴轴套(中)螺钉	SCREW SM15/64"×28 L=10	3	3	3	3
18	124.09-18	2304042	挑线杆定位螺钉	SCREW	1	1	1	1
19	124.09-19	2303266	圆柱头螺钉	SCREW SM15/64"×28 L=14	1	1	1	1
20	124.09-20	2303263	送布轴曲柄(中)	FEED ROCK SHAFT CRANK (MIDDLE)	1	1	1	1
21	124.09-21	2301086	上轴紧圈螺钉	SCREW SM1/4"×40 L=8	2	2	2	2
22	124.09-22	2303293	下轴右轴套	BUSHING	1	1	1	1
23	124.09-23	2303292	轴承	BALL BEARIGN	1	1	1	1
24	124.09-24	2303294	挡板	BEARING HOLDER	1	1	1	1
25	124.09-25	2303424	送布凸轮垫圈螺钉	SCREW	3	3	3	3
26	124.09-26	2303249	牙架	FEED BAR	1	1	1	1
27	124.09-27	GB78-85	内装六角紧定螺钉	SCREW	1	1	1	1
28	124.09-28	2303255	油线	OIL WICK	1	1	1	1
29	124.09-29	2303258	牙架曲柄轴	FEED BAR SHFT	1	1	1	1
30	124.09-30	2301132	六角螺母	NUT	1	1		
31	124.09-31	2303130	圆柱头螺钉	SCREW	1	1	1	1
32	124.09-32	2303131	油线	OIL WICK	1	1	1	1
33	124.09-33	2303135	送布轴曲柄(右)	FEED ROCK SHAFT CRANK (RIGHT)	1	1		
34	124.09-34	2301207	压脚摆动曲柄(右)螺钉	SCREW SM1/4"×24 L=16	1	1	1	1
35	124.09-35	2303010	送布轴轴套	FEED ROCK SHAFT BUSHING	1	1	1	1
36	124.09-36	2301085	上轴紧圈	COLLAR	2	2	2	2
37	124.09-37	2301086	上轴紧圈螺钉	SCREW SM1/4"×40 L=8	4	4	4	4
38	124.09-38	2303246	送布轴	FEED ROCK SHAFT	1	1	1	1
39	124.09-39	2303247	羊毛毡	FELT	2	2	2	2
40	124.09-40	2301172	抬牙轴轴套	FEED ROCK SHAFT BUSHING(LEFT)	1	1	1	1
41	124.09-41	2301162	牙架曲柄螺钉	SCREW SM3/16"×28 L=12	2	2	2	2
42	124.09-42	2303256	牙架曲柄	FEED BAR CRANK	1	1	1	1
43	124.09-43	2303248	油线	OIL WICK	1	1	1	1
44	124.09-44	2303259	毛线夹	HOLDER	1	1	1	1
45	124.09-45	2303291	六角螺栓	BOLT	1	1	1	1
46	124.09-46	2301249	垫圈	WASHER	1	1	1	1
47	124.09-47	GB78-85	内六角紧定螺钉	SCREW	1	1	1	1
48	124.09-48	GB170-86	螺母	NUT	1	1	1	1
49	124.09-49	2303286	抬牙曲柄叉	FEED BAR CONNECTING FORK	1	1	1	1
50	124.09-50	2303287	羊毛毡	OIL WICK	1	1	1	1
51	124.09-51	2303288	圆柱头螺钉	SCREW SM1/8"×44 L=4	1	1	1	1
52	124.09-52	2303253	内六角螺栓	BOLT SM1/8"×28 L=7	2	2	2	2
53	124.09-53	2303254	送布牙1/4	FEED DOG 1/4	1		1	
	124.09-53	2303462	送布牙1/5	FEED DOG 1/5		1		1
54	124.09-54	2303605	止动环	STOPPER RING	1	1	1	1
55	124.09-55	2301151	牙架曲柄螺钉	SCREW SM3/16"×28 L=15			1	1
56	124.09-56	2303503	送布曲柄	FEED BAR CONNECTING FORK			1	1
57	124.09-57	2303504	销	PIN			1	1
58	124.09-58	2304038	滑杆棉线	OIL WICK			1	1
59	124.09-59	2303366	油管接头	OIL RUBD JOINT	3	3	3	3
60	124.09-60	2303261	送布连杆轴	FEED ROCKER SHAFT	1	1	1	1

10、旋梭台部件
HOOK SADDLE MECHANISM

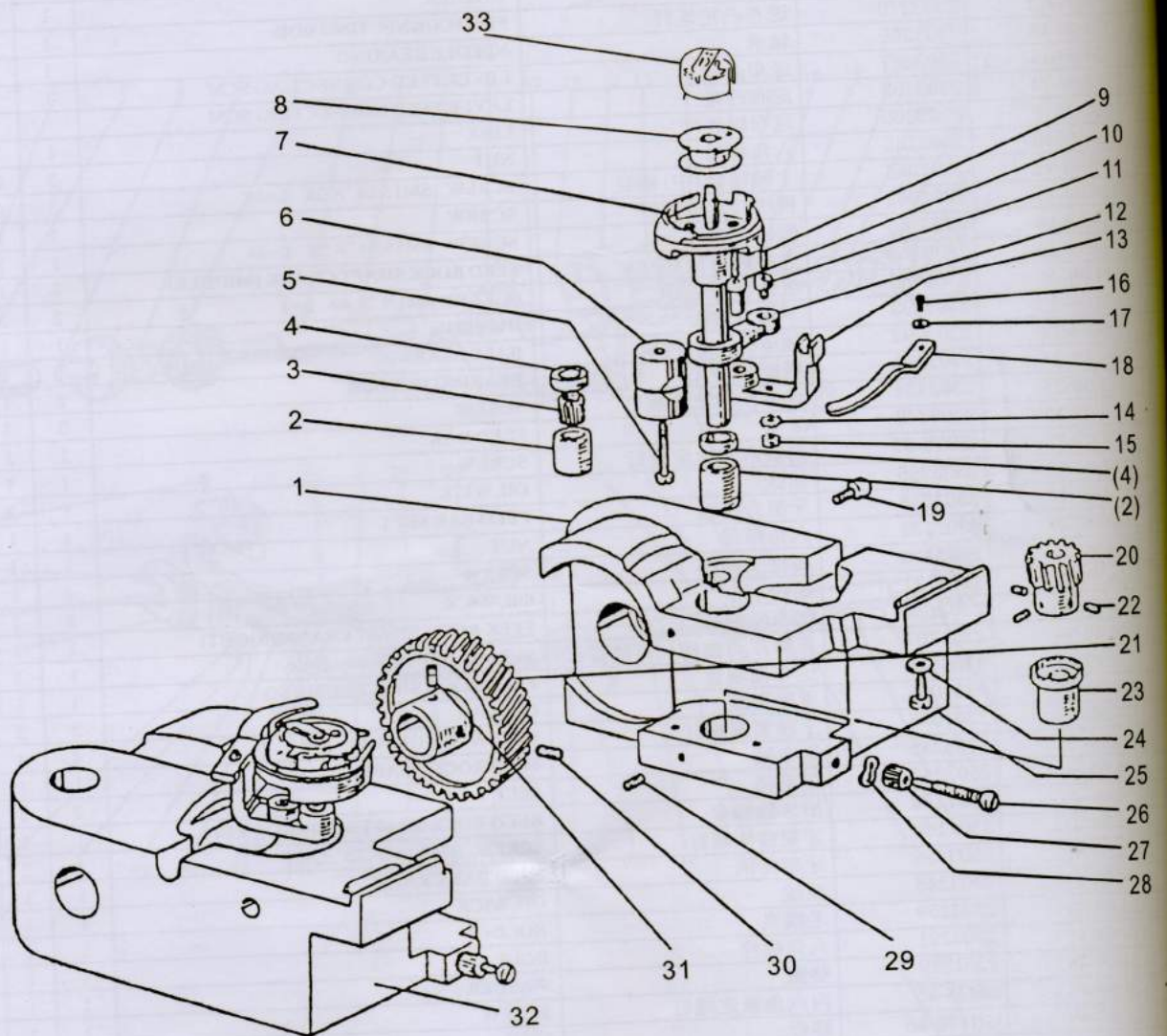

11、供油部件

OIL LUBRICATION MECHANISM

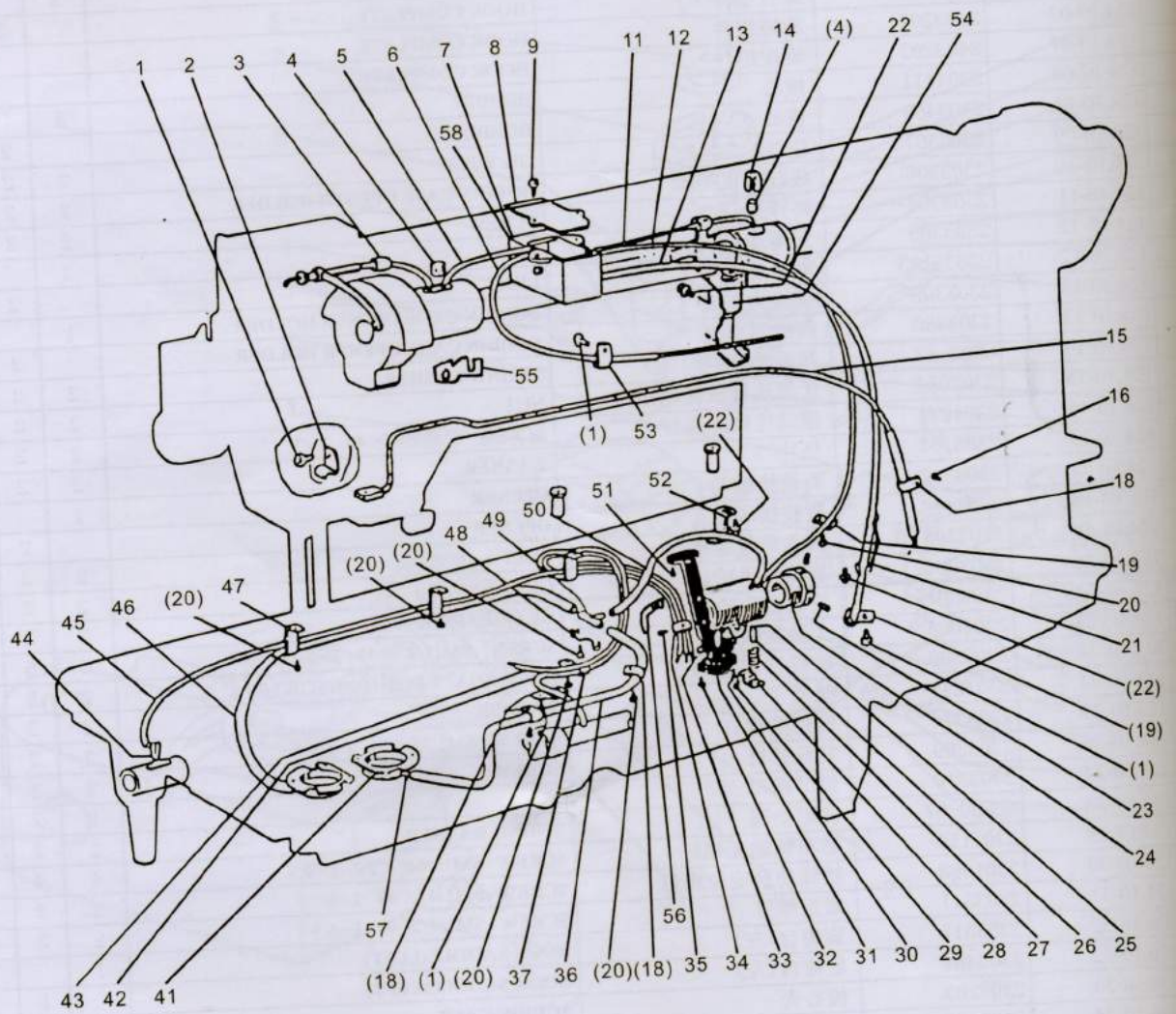

11.供油部件 OIL LUBRICATION MECHANISM

序号 NO.	图号 REF. NO.	老图号	零件名称	DESIGNATION	1M	1B	2M	2B
1	124.11-01	2301066	挑线杆防护罩螺钉	SCREW SM11/64"×40 L=8	4	4	4	4
2	124.11-02	2303356	油管夹	HOLDER	1	1	1	1
3	124.11-03	2303103	橡胶管	PIPE	1	1	1	1
4	124.11-04	2303012	羊毛毡	FELT	2	2	1	1
5	124.11-05	2403214	油管组件	OIL PIPE	1	1	1	1
6	124.11-06	2403215	油管组件	OIL PIPE	1	1	1	1
7	124.11-07	2303339	油盒	OIL PIPE	1	1	1	1
8	124.11-08	2303352	油盒垫片	GASKET	1	1	1	1
9	124.11-09	GB819-85	螺钉	SCREW	2	2	2	2
11	124.11-11	2403216	油管组件	OIL PIPE	1	1		
12	124.11-12	2303347	油管	OIL PIPE	1	1	1	1
13	124.11-13	2303348	油管	OIL PIPE	1	1	1	1
14	124.11-14	2303389	上轴轴套油管	PIPE	1	1		
15	124.11-15	2403217	没管组件	OIL PIPE	1	1	1	1
16	124.11-16	2303419	偏心连杆轴螺钉	SCREW SM9/64"×40 L=6.5	7	7	7	7
18	124.11-18	2303128	油管夹	HOLDER	2	2	2	2
19	124.11-19	2303385	油管夹	HOLDER	2	2	2	2
20	124.11-20	2301053	大线勾螺钉	SCREW SM11/64"×40 L=5.5	7	7	7	7
21	124.11-21	2303386	油管夹	HOLDER	1	1	1	1
22	124.11-22	2301017	后盖板螺钉	SCREW SM11/64"×40 L=6	3	3	3	3
23	124.11-23	2303394	紧定螺钉	SCREW SM11/64"×40 L=10	2	2	2	2
24	124.11-24	2303395	轴套	BUSHING	1	1	1	1
25	124.11-25	2303374	油管	OIL PIPE	1	1	1	1
26	124.11-26	2301263	柱塞	PLUNGER	1	1	1	1
27	124.11-27	2301264	柱塞弹簧	PLUNAER SPRING	1	1	1	1
28	124.11-28	2301265	柱塞弹簧挡板	PLUNAER SPRING PLATE	1	1	1	1
29	124.11-29	2303122	圆柱头螺钉	SCREW SM1/8"×44 L=4.8	1	1	1	1
30	124.11-30	2303142	圆柱头螺钉	SCREW SM9/64"×40 L=5	1	1	1	1
31	124.11-31	2303370	过滤板	FILTER	1	1	1	1
32	124.11-32	2303372	圆柱头螺钉	SCREW SM9/64"×40 L=7	1	1	1	1
33	124.11-33	2303369	油管板	BASE PLATE	1	1	1	1
34	124.11-34	2303373	油管夹	HOLDER	1	1	1	1
35	124.11-35	2301013	面板线勾螺钉	SCREW SM9/64"×40 L=6	1	1	1	1
36	124.11-36	2303360	油管	OIL PIPE	1	1	1	1
37	124.11-37	2303381	油管夹	HOLDER	1	1	1	1
41	124.11-41	2303365	供油管盖	COVER	2	2	2	2
42	124.11-42	2403224	油管组件	OIL PIPE	1	1	1	1
43	124.11-43	2403223	油管组件	OIL PIPE	1	1	1	1
44	124.11-44	2303384	油线	OIL WICK	3	3	3	3
45	124.11-45	2403222	油管组件	OIL PIPE	1	1	1	1
46	124.11-46	2303361	油管	OIL PIPE	1	1	1	1
47	124.11-47	2303380	油管夹	HOLDER	3	3	3	3
48	124.11-48	2303363	油管夹	HOLDER	1	1	1	1
49	124.11-49	2303359	三通油管	OIL PIPE	1	1	1	1
50	124.11-50	2303362	油管	OIL PIPE	1	1	1	1
51	124.11-51	2301123	旋梭定位勾螺钉	SCREW SM11/64"×40 L=10	2	2	2	2
52	124.11-52	2303391	压板	HOLDER PLATE	1	1	1	1
53	124.11-53	2303353	塑料夹	HOLDER	1	1	1	1
54	124.11-54	2303354	油管夹	HOLDER	1	1	1	1
55	124.11-55	2303351	压板	HOLDER PLATE	1	1	1	1
56	124.11-56	2303368	油管接头	OIL RUBD JOINT	1	1	1	1
57	124.11-57	2303366	油管接头	OIL RUBD JOINT	2	2	2	2
58	124.11-58	2303338	油盒盖	OIL PIPE	1	1	1	1

12、附件
ACCESSORIES

